

5.5 to 7.0GHz Drop in Isolator

WG1220D Drop-In Type

Outline Drawing (mm):

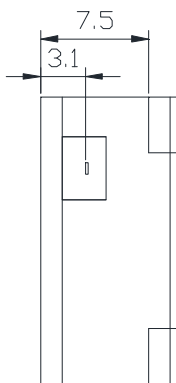
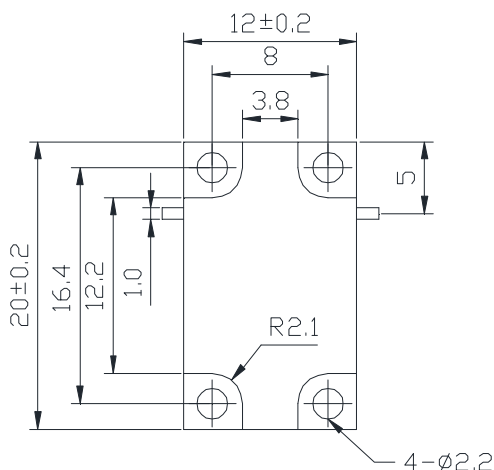
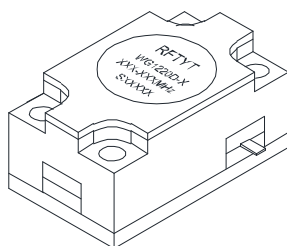
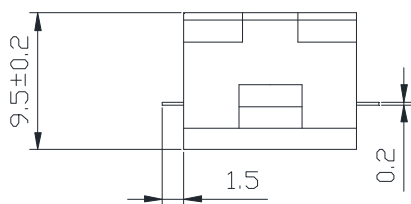
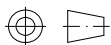

Features:

- ✧ Good temperature stability
- ✧ Withstand high power
- ✧ RoHS compliant
- ✧ Weight : ~ g

Material list:

- ✧ Cavity: aluminum conductive oxidation
- ✧ Outer shell: industrial pure iron nickel plating
- ✧ Guide body: Silver plated brass
- ✧ Load chamber: aluminum conductive oxidation

Application:

- ✧ Rf amplifier final stage, protect the amplifier
- ✧ Common transceiver antenna
- ✧ High capacity microwave relay communication

Order Examples:

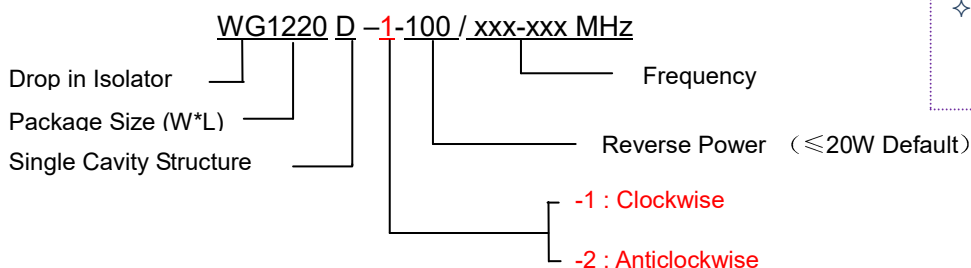

Basic Specifications:

Impedance	50 Ω
Size(mm)	16.0*23.0*9.7
Operating Temp	-30~+70℃/-40~+85℃
Storage temperature	-50~+90℃

Specifications:

Model No. (X=1: →Clockwise) (X=2: ←Anticlockwise)	Freq. Range GHz	IL. dB (max)	Isolation dB (min)	VSWR	Forward Power CW	Reverse Power W
WG1220D-X/5.5-5.7GHz	5.5-5.7	0.40	20.0	1.20	30	5
WG1220D-X/5.6-6.0GHz	5.6-6.0	0.40	19.0	1.25	30	5
WG1220D-X/5.7-5.9GHz	5.7-5.9	0.30	23.0	1.20	30	5
WG1220D-X/5.7-6.5GHz	5.7-6.5	0.50	18.0	1.30	30	5
WG1220D-X/5.78-6.0GHz	5.78-6.0	0.40	20.0	1.20	30	5
WG1220D-X/5.8-6.5GHz	5.8-6.5	0.50	18.0	1.30	30	5
WG1220D-X/5.85-6.73GHz	5.85-6.73	0.50	18.0	1.30	30	5
WG1220D-X/6.0-7.0GHz	6.0-7.0	0.50	18.0	1.30	30	5
WG1220D-X/6.35-6.55GHz	6.35-6.55	0.30	23.0	1.20	30	5
WG1220D-X/6.5-7.0GHz	6.5-7.0	0.40	20.0	1.25	30	5
WG1220D-X/6.57-6.87GHz	6.57-6.87	0.30	20.0	1.20	30	5
WG1220D-X/6.7-7.0GHz	6.7-7.0	0.30	20.0	1.20	30	5

**If the frequency range you need is not covered in the form.
Please contact us for details.**